

 **Vista Lateral**
ESC 1:50 ATUAL

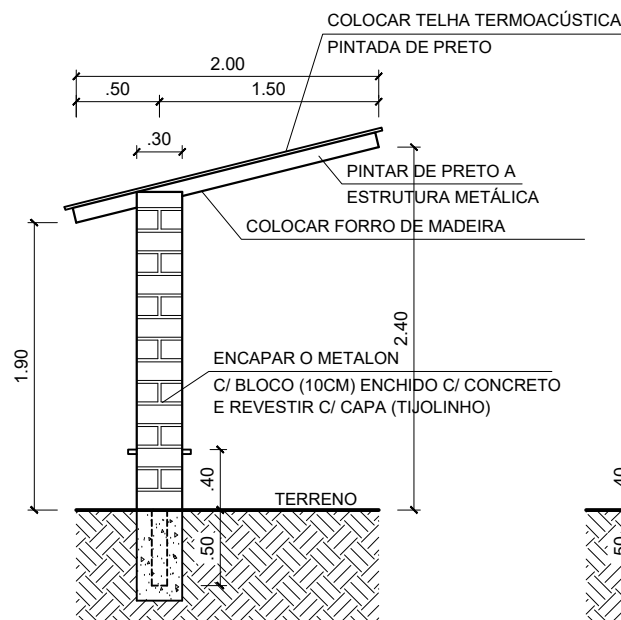

 **Vista Lateral**
ESC 1:50 REFORMA

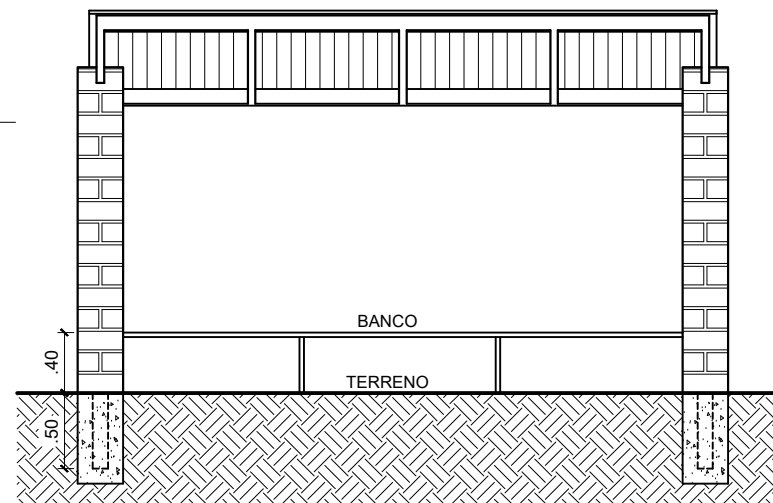

 **Vista Frontal**
ESC 1:50 REFORMA

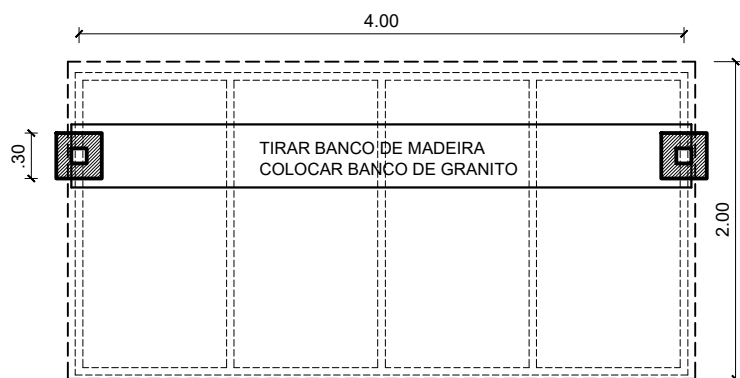

 **Planta Baixa**
ESC 1:50 REFORMA

ÁREAS

ABRIGO 8,00 M²



PREFEITURA DE CASIMIRO DE ABREU

LOCAL SEDE, CASIMIRO DE ABREU - RJ		FOLHA 01 / 01
Reforma nos Abrigos do Transporte Urbano		ESCALA INDICADA
		Nº PROJETO 001
AUTOR DO PROJETO ARQ FABIO KIFFER	VISTO	DESENHO WÉZELEN FARIA